

KWG201 series

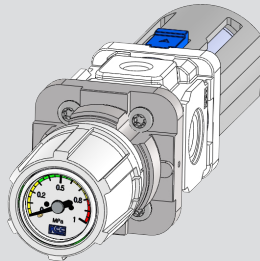

KWG201-02

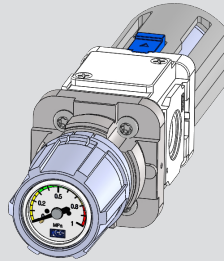

KWG201-02A

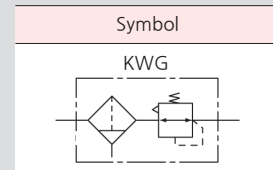

Features

- Increased pressure gauge recognition at various installation locations
- Save space and reduce maintenance costs

How to order

※ The symbols are displayed alphabetically.

KWG201 - 02 Ga - -

① Model

KWG201	Rc(PT) 1/4 IN, OUT Port type
KWG201A	Rc(PT) 1/4 Block Cover type

※ Only KWG201A model is available for the check valve type.

② Thread type

Nil	Rc(PT) (Standard)
G	G
N	NPT

③ Port size

02	1/4
----	-----

④ Filtration grade

Nil	5 μ m(Standard)
2	20 μ m(Optional)
4	40 μ m(Optional)

⑤ Bracket

Nil	None (Standard)
B	L Bracket + Nut

⑥ Drain

Nil	Manual drain (Standard)
D	Auto drain (N.O)

⑦ Pressure gauge installation angle

Symbol	Ga	Gb	Gc	Gd
Installation angle	0°	90°	180°	270°

※ It changeable other angle.

⑧ Regulating range

Nil	0.05 ~ 0.85MPa (Standard)
2	0.02 ~ 0.2MPa
4	0.02 ~ 0.4MPa

⑨ Bowl

Nil	Polycarbonate bowl
M	Metal bowl

⑩ Check valve

Nil	None (Standard)
C	Built-in check valve

※ When ordering the attached check valve, order the model KWG201A.

⑪ Relief

Nil	Relief (Standard)
N	Non-relief

⑫ Airflow direction

Nil	Left(IN) ▶ Right(OUT) (Standard)
R	Right(IN) ▶ Left(OUT)

Specifications

Fluid	Air
Proof pressure	1.5MPa
Max. operating pressure	1.0MPa
Regulating pressure range	0.05~0.85MPa
Ambient & fluid temperature	-5 ~ 60°C (No freezing)
Filtration grade	Standard 5 μ m, Option 20, 40 μ m
Bowl material	Polycarbonate (Standard) / Metal
Structure	Relief type (Standard)
Gauge connection	Rc(PT) 1/8"(2 locations)
Weight(g)	250

Flow rate

Condition: Inlet pressure 0.7Mpa

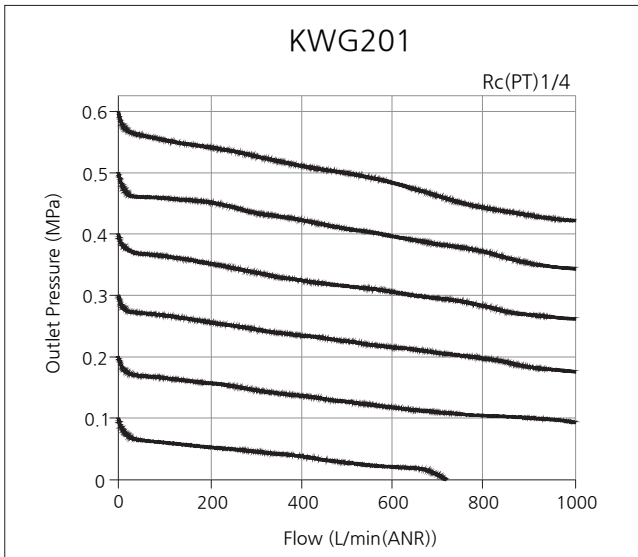

※ The data above are representative measurements and are not guaranteed values.
※ Flow rates may vary depending on piping and setting conditions.

Flow rate

Condition: Inlet pressure 0.7Mpa,
Outlet pressure 0.2Mpa

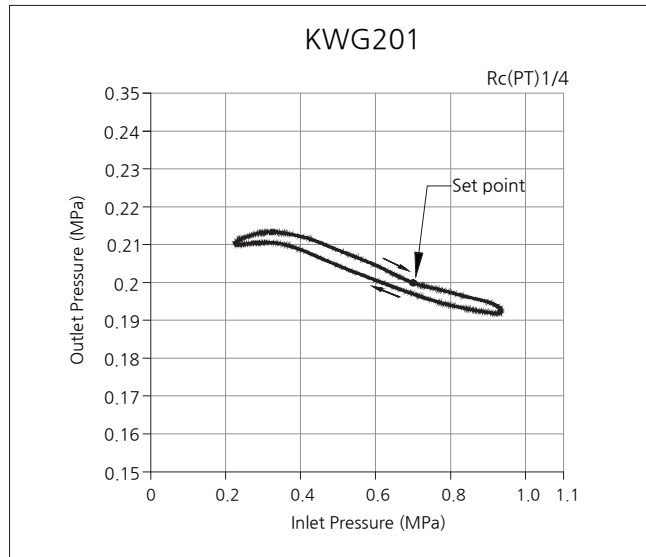

Structure

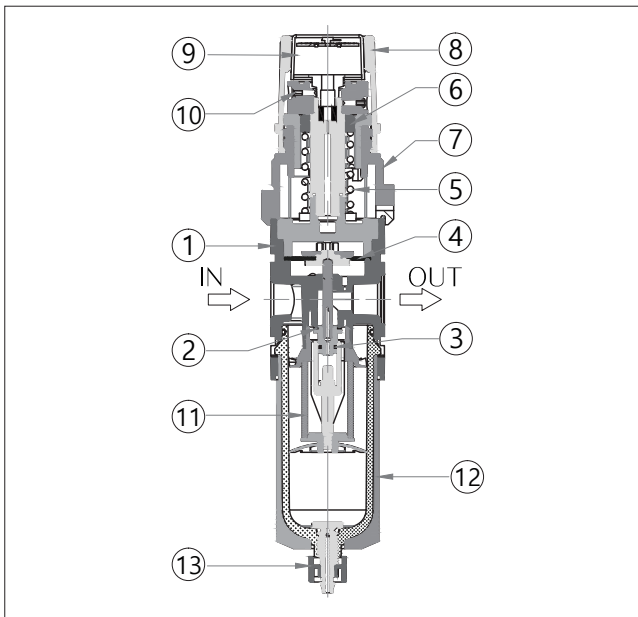

No.	Parts	Materials
1	Body	ALDC
2	Valve seat	NBR
3	O ring	NBR
4	Diaphragm Ass'y	NBR, C3604
5	Spring	STEEL
6	Adjust Bolt Ass'y	STEEL
7	Bonnet	NYLON
8	Handle	POM
9	Pressure Gauge	-
10	Set Screw	STEEL
11	Filter Element	PPF
12	Bowl assembly	PLASTIC
13	Drain assembly	PLASTIC

Dimensions

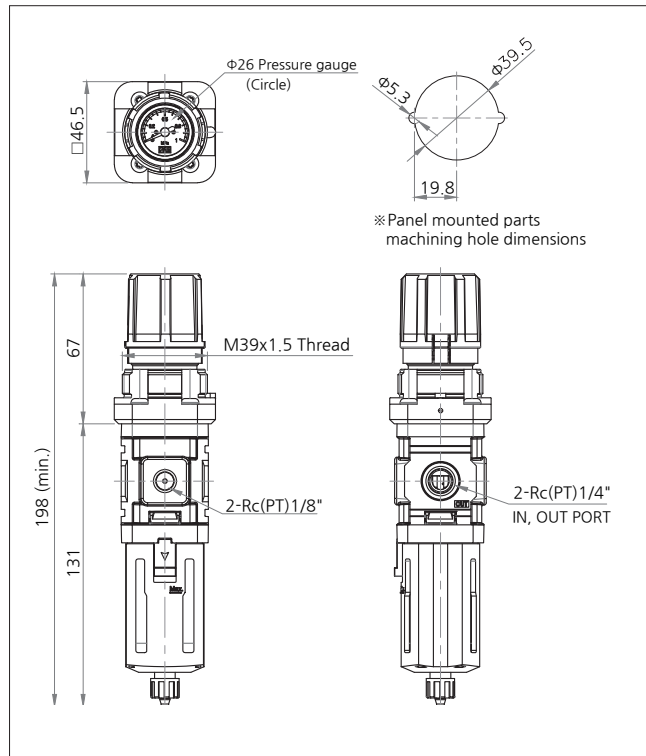

Pressure gauge installation angle

■ Typical Angle

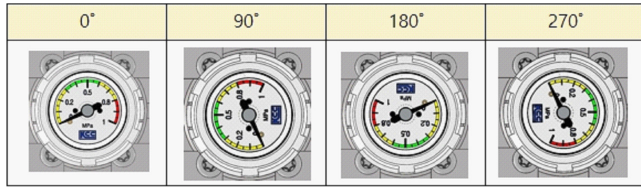

■ Other example : Adjustable angle as desired

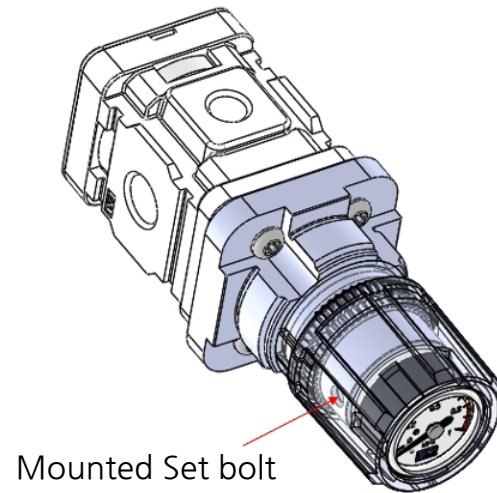
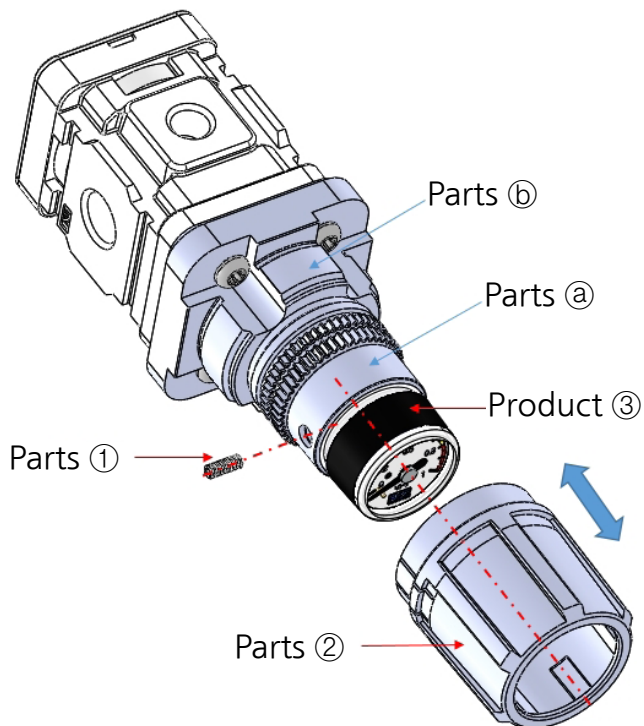
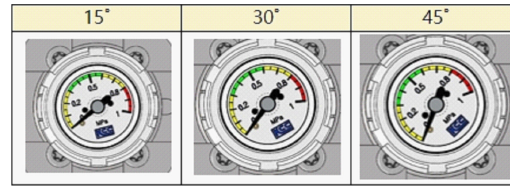

[Assembly status after adjusting pressure gauge angle]

[When adjusting the pressure gauge angle]

1. Disassemble parts②(handle) and parts①(set bolt) from the main body.
2. Turn the product③(pressure gauge) to the desired angle.
3. Attach the set bolt to the component parts④(pressure gauge fixing housing).