

# HPS102NO, 103NO

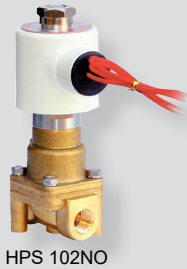

HPS 102NO

Symbol					
Electrical connection					
Nil	G	T	TZ	D	Z

## How to Order

**HPS**    10 2 **NO**    - AC220V

①
②
③
④
⑤

### ① Port type

Nil	Rc(PT) (Standard)
G	G

### ② Orifice

10	Ø10
----	-----

### ③ Port size

2	1/4
3	3/8

### ④ Electrical connection

Nil	Console box (Standard)
G	Grommet coil
T	Console box + Terminal box
TZ	Console box + Terminal box (Lamp)
D	DIN coil + DIN connector
Z	DIN coil + DIN connector (Lamp)

### ⑥ Rated voltage

AC110V	AC110V 60Hz
AC220V	AC220V 60Hz
DC24V	DC24V
AC100V	AC100V 50/60Hz
AC200V	AC200V 50/60Hz
AC220V-50Hz	AC 220V 50Hz
AC240V-50Hz	AC 240V 50Hz
AC24V-50Hz	AC 24V 50Hz

## Specifications

Classification	Standard	Option	Classification	Standard	Option
Fluid	Air, Steam, Hot water		Voltage	AC100V 50/60Hz	AC220V 50Hz
Fluid temp.	0 ~ 180 °C			AC110V 60Hz	
Ambient temp.	50 °C (Max.)			AC200V 50/60Hz	
Pressure range	0.5 ~ 7kgf/cm <sup>2</sup> (0.05 ~0.7MPa)		Allowable voltage fluctuation	±10%(AC), ±5% (DC)	
Coil insulation	Class H		Power consumption	AC, DC : 14W	
Electrical connection	Lead wire G(PF) 1/2	Grommet coil Terminal box DIN connector	Body material	Brass	
Port size	Rc(PT) 1/4, 3/8		Seal material	PTFE + SUS 304 PISTON	
Orifice	Ø10		Weight	0.7kg	

\* Not available in explosive atmosphere.

## Features

- Piston pilot type
- Normally open type
- Max. temperature 180 °C, large capacity
- Fire resistant structure, high durability

## Applications

- Steam piping
- Steam presser
- Sterilizer
- Industrial cleaner
- Dyeing machine
- Medical instrument

## Dimensions

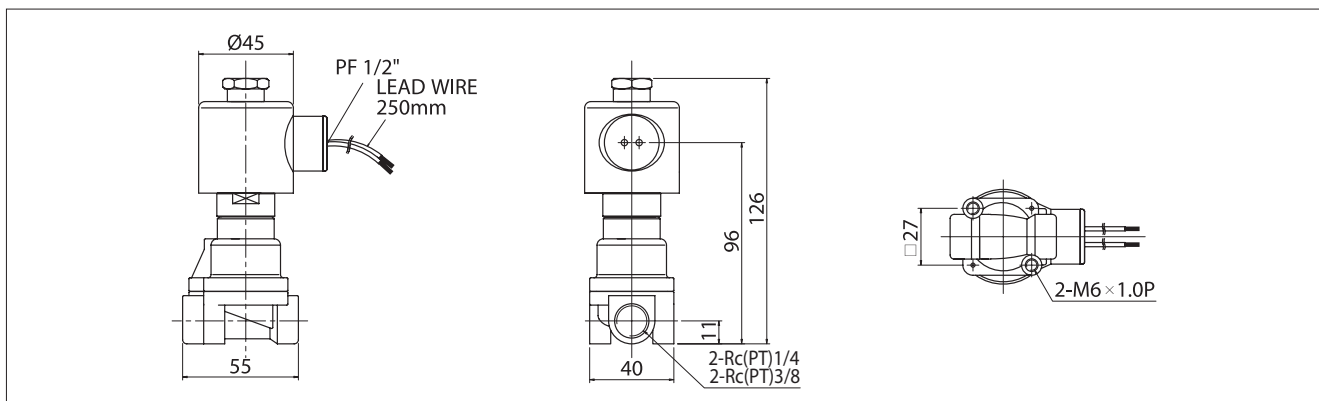

# HPS154NO

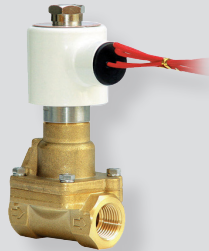

HPS 154NO

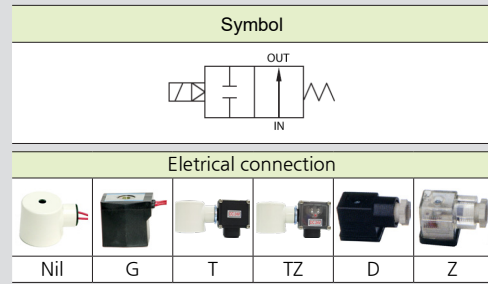

## How to Order

HPS   15 4 **NO**   - AC220V

①
②
③
④
⑤

### ① Port type

Nil	Rc(PT) (Standard)
G	G

### ② Orifice

15	Ø15
----	-----

### ③ Port size

4	1/2
---	-----

### ④ Electrical connection

Nil	Console box (Standard)
G	Grommet coil
T	Console box + Terminal box
TZ	Console box + Terminal box (Lamp)
D	DIN coil + DIN connector
Z	DIN coil + DIN connector (Lamp)

### ⑥ Rated voltage

AC110V	AC110V 60Hz
AC220V	AC220V 60Hz
DC24V	DC24V
AC100V	AC100V 50/60Hz
AC200V	AC200V 50/60Hz
AC220V-50Hz	AC 220V 50Hz
AC240V-50Hz	AC 240V 50Hz
AC24V-50Hz	AC 24V 50Hz

## Specifications

Classification	Standard	Option	Classification	Standard	Option
Fluid	Air, Steam, Hot water		Voltage	AC100V 50/60Hz	AC220V 50Hz AC240V 50Hz AC 24V 50Hz
Fluid temp.	0 ~ 180 °C			AC110V 60Hz	
Ambient temp.	50 °C (Max.)			AC200V 50/60Hz	
Pressure range	0.5 ~ 7kgf/cm <sup>2</sup> (0.05 ~ 0.7MPa)		Allowable voltage fluctuation	±10%(AC), ±5% (DC)	
Coil insulation	Class H		Power consumption	AC, DC : 14W	
Electrical connection	Lead wire	Grommet coil Terminal box DIN connector	Body material	Brass	
Port size	Rc(PT) 1/2		Seal material	PTFE + SUS 304 PISTON	
Orifice	Ø15		Weight	0.9kg	

## Features

- Piston pilot type
- Normally open type
- Max. temperature 180 °C, large capacity
- Fire resistant structure, high durability

## Applications

- Steam piping
- Steam presser
- Sterilizer
- Industrial cleaner
- Ventilator
- Medical Instrument

\* Not available in explosive atmosphere.

## Dimensions

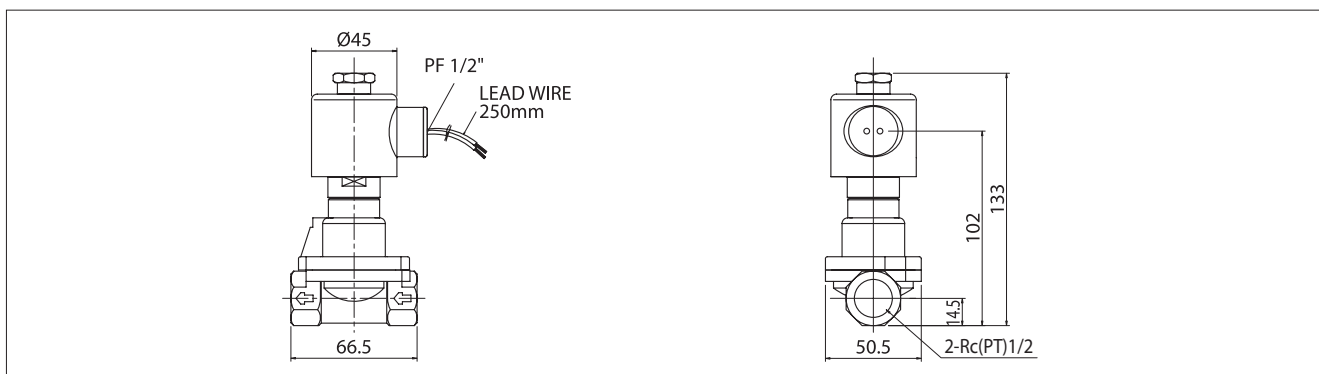

# HPS206NO~5020NO



HPS 3212NO

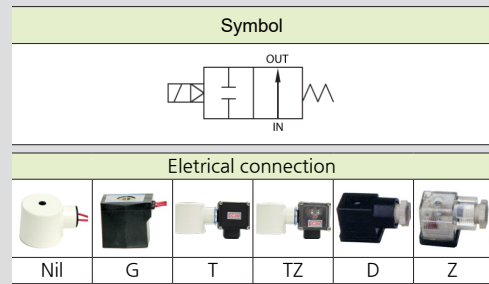

## How to Order

HPS    3212 NO    - AC220V

①
②
③
④

### ① Port type

Nil	Rc(PT) (Standard)
G	G

### ② Orifice & Port size

	Orifice	Port size
206	Ø20	3/4
2510	Ø25	1
3212	Ø32	1 1/4
4014	Ø40	1 1/2
5020	Ø50	2

### ④ Electrical connection

Nil	Console box (Standard)
G	Grommet coil
T	Console box + Terminal box
TZ	Console box + Terminal box (Lamp)
D	DIN coil + DIN connector
Z	DIN coil + DIN connector (Lamp)

### ⑥ Rated voltage

AC110V	AC110V 60Hz
AC220V	AC220V 60Hz
DC24V	DC24V
AC100V	AC100V 50/60Hz
AC200V	AC200V 50/60Hz
AC220V-50Hz	AC 220V 50Hz
AC240V-50Hz	AC 240V 50Hz
AC24V-50Hz	AC 24V 50Hz

## Specifications

Classification	Standard	Option	Classification	Standard	Option
Fluid	Air, Steam, Hot water		Voltage	AC100V 50/60Hz AC110V 60Hz AC200V 50/60Hz AC220V 60Hz DC24V	AC220V 50Hz AC240V 50Hz AC 24V 50Hz
Fluid temp.	0 ~ 180 °C				
Ambient temp.	50 °C (Max.)				
Pressure range	0.5 ~ 7kgf/cm <sup>2</sup> (0.05 ~ 0.7MPa)		Allowable voltage fluctuation	±10%(AC), ±5% (DC)	
Coil insulation	Class H		Power consumption	AC, DC : 14W	
Electrical connection	Lead wire	Grommet coil Terminal box DIN connector	Body material	Brass	
Port size	Rc(PT) 3/4, 1, 1 1/4, 1 1/2, 2		Seal material	PTFE + SUS 304 PISTON	
Orifice	Ø20, Ø25, Ø32, Ø40, Ø50		Weight	Refer to the table below	

\* Not available in explosive atmosphere.

## Features

- Piston pilot type
- Normally open type
- Max. temperature 180 °C
- Fire resistant structure, high durability

## Applications

- Steam piping
- Steam presser
- Sterilizer
- Industrial cleaner
- Dyeing machine
- Medical instrument

## Dimensions

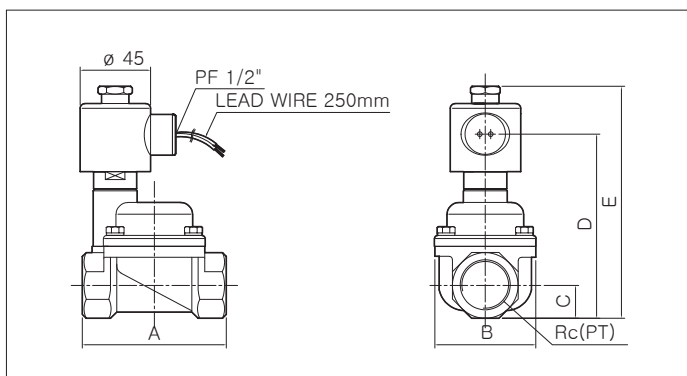

Model	A	B	C	D	E	Rc(PT)	Orifice	Weight (kg)
HPS 206NO	92	64	19	111	141	3/4	Ø20	1.55
HPS 2510NO	92	64	21	123	147	1	Ø25	1.57
HPS 3212NO	122	86	26	140	170	1 1/4	Ø32	2.55
HPS 4014NO	122	86	29	150	174	1 1/2	Ø40	2.75
HPS 5020NO	140	100	36	166	190	2	Ø50	3.92

# HPS6524NO

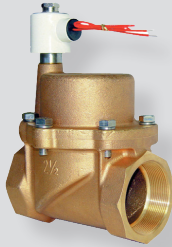

HPS 6524NO

Symbol					
Electrical connection					
Nil	G	T	TZ	D	Z

## How to Order

HPS   65 24 **NO**   - AC220V

①            ②            ③            ④            ⑤

### ① Port type

Nil	Rc(PT) (Standard)
G	G

### ② Orifice

65	Ø65
----	-----

### ③ Port size

24	2 1/2
----	-------

### ④ Electrical connection

Nil	Console box (Standard)
G	Grommet coil
T	Console box + Terminal box
TZ	Console box + Terminal box (Lamp)
D	DIN coil + DIN connector
Z	DIN coil + DIN connector (Lamp)

### ⑥ Rated voltage

AC110V	AC110V 60Hz
AC220V	AC220V 60Hz
DC24V	DC24V
AC100V	AC100V 50/60Hz
AC200V	AC200V 50/60Hz
AC220V-50Hz	AC 220V 50Hz
AC240V-50Hz	AC 240V 50Hz
AC24V-50Hz	AC 24V 50Hz

## Specifications

Classification	Standard	Option	Classification	Standard	Option
Fluid	Air, Steam, Hot water		Voltage	AC100V 50/60Hz	AC220V 50Hz AC240V 50Hz AC 24V 50Hz
Fluid temp.	0 ~ 180 °C			AC110V 60Hz	
Ambient temp.	50 °C (Max.)			AC200V 50/60Hz	
Pressure range	1 ~ 7kgf/cm <sup>2</sup> (0.1 ~ 0.7MPa)		Allowable voltage fluctuation	±10%(AC), ±5% (DC)	
Coil insulation	Class H		Power consumption	AC, DC : 14W	
Electrical connection	Lead wire	Grommet coil Terminal box DIN connector	Body material	Bronze	
Port size	Rc(PT) 2 1/2		Seal material	PTFE + SUS 304 PISTON	
Orifice	Ø65		Weight	8.3kg	

## Features

- Piston pilot type
- Normally open type
- Max. temperature 180 °C, large capacity
- Fire resistant structure, high durability

## Applications

- Steam piping
- Steam presser
- Sterilizer
- Industrial cleaner
- Ventilator
- Heat exchanger

\* Not available in explosive atmosphere.

## Dimensions

