

HDS021, 022 series

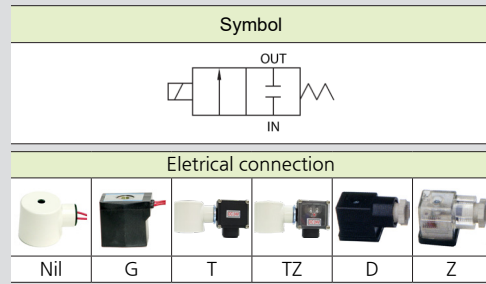

HDS 021



How to Order

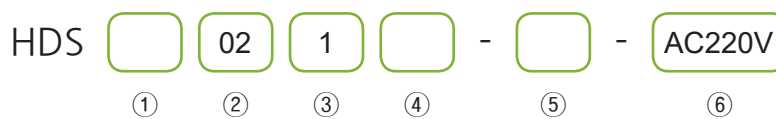

① Port type

Nil	Rc(PT) (Standard)
G	G

② Orifice

02	Ø1.5 (Standard)
02A	Ø2

③ Port size

1	1/8
2	1/4

④ Electrical connection

Nil	Console box (Standard)
G	Grommet coil
T	Console box + Terminal box
TZ	Console box + Terminal box (Lamp)
D	DIN coil + DIN connector
Z	DIN coil + DIN connector (Lamp)

⑤ Seal material

Nil	FPM	Chemical, Hot water 120°C
T	PTFE	Chemical, Hot water 180°C

⑥ Rated voltage

AC110V	AC110V 60Hz
AC220V	AC220V 60Hz
DC24V	DC24V
AC100V	AC100V 50/60Hz
AC200V	AC200V 50/60Hz
AC220V-50Hz	AC 220V 50Hz
AC240V-50Hz	AC 240V 50Hz
AC24V-50Hz	AC 24V 50Hz

Specifications

Classification	Standard	Option	Classification	Standard	Option
Fluid	Air, Water, Steam, Hot water, Clean oil, Inert gas		Voltage	AC100V 50/60Hz AC110V 60Hz AC200V 50/60Hz AC220V 60Hz DC24V	AC220V 50Hz AC240V 50Hz AC 24V 50Hz
Fluid temp.	0 ~ 140°C				
Ambient temp.	50°C (Max.)				
Pressure range	0 ~ 10kgf/cm ² (0 ~ 1.0MPa)	DC:0~10kgf/cm ² (0 ~ 1.0MPa)	Allowable voltage fluctuation	±10% (AC), ±5% (DC)	
Coil insulation	Class H		Power consumption	AC, DC : 14W	
Electrical connection	Lead wire G(PF)1/2	Grommet coil Terminal box DIN connector	Body material	Brass	
Port size	Rc(PT)1/8, 1/4		Seal material	FPM	PTFE
Orifice	Ø1.5	Ø2	Weight	0.5kg	

Features

- Direct acting type
- Normally closed type
- Easy to attach
- Fire resistant structure, high durability

Applications

- Steam piping
- Steam cooker
- Sterilizer
- Wire cutting machine
- Industrial cleaner
- Medical instrument
- Water purifier

※ Not available in explosive atmosphere.
 ※ If oil is applied, the range of pressure shall be based on 50cst for oil viscosity.

Dimensions

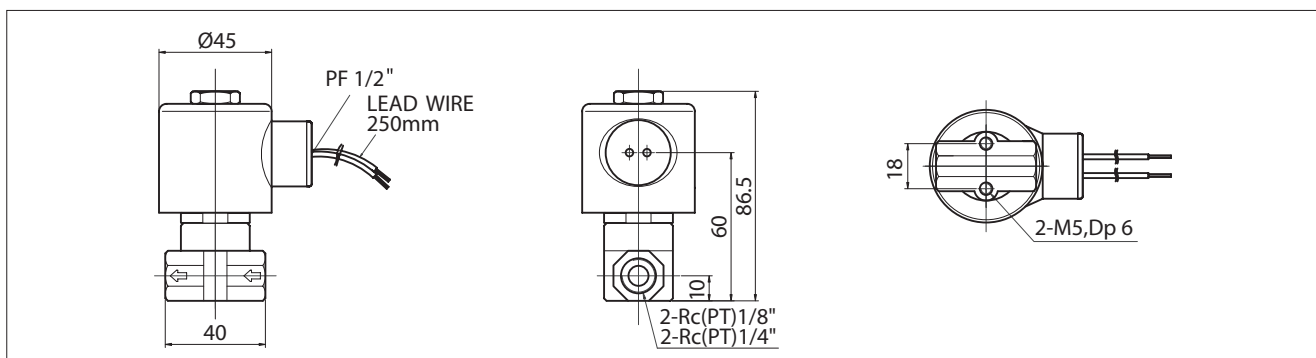

HDS042, 043 series

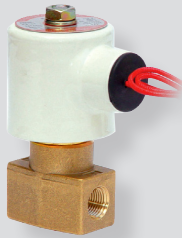

HDS 042

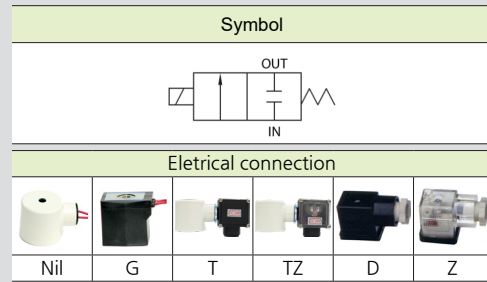

How to Order

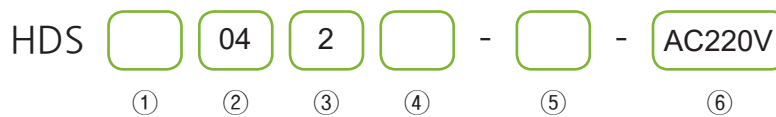

① Port type

Nil	Rc(PT) (Standard)
G	G

② Orifice

04	Ø5 (Standard)
04A	Ø2
04B	Ø3

③ Port size

2	1/4
3	3/8

④ Electrical connection

Nil	Console box (Standard)
G	Grommet coil
T	Console box + Terminal box
TZ	Console box + Terminal box (Lamp)
D	DIN coil + DIN connector
Z	DIN coil + DIN connector (Lamp)

⑤ Seal material

Nil	FPM	Chemical, Hot water 120°C
T	PTFE	Chemical, Hot water 180°C

⑥ Rated voltage

AC110V	AC110V 60Hz
AC220V	AC220V 60Hz
DC24V	DC24V
AC100V	AC100V 50/60Hz
AC200V	AC200V 50/60Hz
AC220V-50Hz	AC 220V 50Hz
AC240V-50Hz	AC 240V 50Hz
AC24V-50Hz	AC 24V 50Hz

Specifications

Classification	Standard	Option	Classification	Standard	Option
Fluid	Air, Water, Steam, Hot water, Clean oil, Inert gas		Voltage	AC100V 50/60Hz	AC220V 50Hz
Fluid temp.	0 ~ 140 °C			AC110V 60Hz	AC240V 50Hz
Ambient temp.	50 °C (Max.)			AC200V 50/60Hz	AC 24V 50Hz
Pressure range	0 ~ 7kgf/cm ² (0 ~ 0.7MPa)	DC: 0 ~ 7kgf/cm ² (0 ~ 0.7MPa)	Allowable voltage fluctuation	±10% (AC), ±5% (DC)	
Coil insulation	Class H		Power consumption	AC, DC : 14W	
Electrical connection	Lead wire	Grommet coil Terminal box DIN connector	Body material	Brass	
Port size	Rc(PT)1/4, 3/8		Seal material	FPM	PTFE
Orifice	Ø5	Ø2, Ø3	Weight	0.5kg	

Features

- Direct acting type
- Normally closed type
- Easy to attach
- Fire resistant structure, high durability

Applications

- Steam piping
- Steam cooker
- Sterilizer
- Wire cutting machine
- Industrial cleaner
- Medical instrument
- Water purifier

※ Not available in explosive atmosphere.

※ If oil is applied, the range of pressure shall be based on 50cst for oil viscosity.

Dimensions

