

KMC72 series

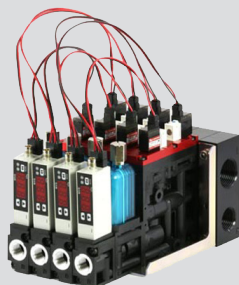

Features

- High vacuum flow type
- Best choice for suction the workpieces with porous surface and heavy workpieces
- Holding workpiece at an emergency stop
- Can be mounted on manifold, up to 5 units

How to order

KMC72 **S** **15** **H** **S** **VG** **C** **4** **B** **L** **R** **1**

① ② ③ ④ ⑤ ⑥ ⑦ ⑧ ⑨ ⑩ ⑪

① Body type

S	Single unit
M	Manifold unit

② Nozzle size

15	Ø1.5
20	Ø2.0
25	Ø2.5

③ Maximum vacuum pressure

H	-87kPa
L	-53kPa

④ Supply pressure

S	0.5MPa
R	0.38MPa

Note) ②③④ applicable models

②	③	④	
		S	R
15	H	O	O
	L	O	X
20	H	O	O
	L	O	X
25	H	O	X
	L	X	X

⑤ Pressure sensor

	Sensor type	Pressure	Display	Switch output	Analog output	Input specification
AB	MVS-030AB	Vacuum	LED	NPN1 point	None	Without
ABP	MVS-030AB	Vacuum	LED	PNP1 point	None	Without
VG	MPS-V23	Vacuum	Digital	NPN2 point	DC1~5V	Without
VGP	MPS-V23	Vacuum	Digital	PNP2 point	DC1~5V	Without
21	MVS-201	Compound	Digital	NPN1 point	None	Sink
21P	MVS-201	Compound	Digital	PNP1 point	None	Sink
ZZ	Without sensor (without base)					
ZS	Without sensor (with base)					

⑥ Blow-off Valve/Check valve/Filter

	Blow-off	Check	Filter
C	Solenoid valve	With	With
D	With	None	
E	With	None	
F	None	With	None
G	With	None	
Z	With	None	

⑦ Valve voltage

4	DC24V
---	-------

⑧ Solenoid valve function

A	Nomally open (N.O)
B	Nomally close (N.C)
W	Self-holding ^{note)1}

Note 1) The energy-saving function of a sensor cannot work if the self-holding valve is selected.

⑨ Valve connection

L	Lead wire with connector
---	--------------------------

⑩ Port size

R	Rc(PT) 1/4"(Standard)
N	NPT 1/4-27"
G	G 1/4"

⑪ Number of manifold units

Nil	①: Single type
1	1 unit
2	2 units
3	3 units
4	4 units
5	5 units

Maintenance Parts

- Solenoid valve (with gasket and mounting screws)

CKV010-4E

※ Please contact us for detailed specifications.

- Self-holding solenoid valve (with gasket and mounting screws)

LV290-4E

※ Please contact us for detailed specifications.

- Pressure switch (with O ring, setting screws)

MVS-030AB-MC7

MVS-030ABP-MC7

MPS-V23C-NGA-MC7

MPS-V23C-PGA-MC7

CVK2-C201 (Normally open, Normally close)

CVK2-C201-W (Self-holding)

MVS-201P-MC72 (Normally open, Normally close)

MVS-201P-MC72-W (Self-holding)

※ Please contact us for detailed specifications.

- Manifold

KMC7 - MB - R
①

① Air supply port

R	Rc(PT)1/2"
N	NPT 1/2"
G	G 1/2"

- Manifold base (With mounting screws, spacer and O-ring)

KMC7-MB

- Filter

KMC7 - E
①

① Parts

E	Element
F	Filter kit (with element)
U	Filter unit (with element and base)

- Silencer

CVK-S

Specifications

Model	KMC72□-15			KMC72□-20			KMC72□-25
	HS	LS	HR	HS	LS	HR	HS
Fluid	Non-lubricated air / Non-corrosive gas						
Ambient temperature	0 ~ 60℃ (Without freezing)						
Operating pressure range	0.2 ~ 0.6MPa						
Blow-off flow	100ℓ/min(ANR)						
Solenoid valve function	Normally closed, Normally open, Self-holding						
Filter element filtration	130μm						
Nozzle size	Ø1.5			Ø2.0			Ø2.5
Nominal pressure	0.5MPa		0.35MPa	0.5MPa		0.35MPa	0.5MPa
Vacuum (air) flow ℓ/min(ANR)	55	90	46	95	130 (With check valve110)	80	140 (With check valve120)
Max. vacuum pressure	-87kPa	-53kPa	-87kPa	-87kPa	-53kPa	-87kPa	-87kPa
Air consumption ℓ/min(ANR)	100	100	100	180	180	180	265
Mass	Single (Without sensor): 460g / Manifold single(Without sensor): 400g						

Solenoid valve specifications

	CKV010-4E	LV290-4E
Solenoid valve function	Normally closed (N.C), Normally open (N.O)	Self-holding
Operating voltage	DC24V	
Allowable voltage tolerance	±10%	
Power consumption	1W	
Grade of insulation	B class	
Manual override operation	Non-lock push button	
Display - Surge killer	LED·diode	
Cable	Lead wire with connector (300mm)	

Pressure sensor specifications

	MVS-030	MPS-V23	MVS-201
Fluid	Air (vacuum), non-corrosive gas, non-flammable gas		
Pressure range settings	-10 ~ -101kPa	-0 ~ -101kPa	500 ~ -101kPa
Ambient temperature	0 ~ 50℃ (Without freezing)		
Output type	Switch output	Switch output	Switch output/input
Display	LED	Digital	Digital
Operating voltage	DC12 ~ 24V		DC10.8 ~ 30V

※ MVS-201 has a normally open contact (A) for the solenoid valve for controlling the vacuum generation of the sensor and the solenoid valve for controlling the vacuum breakdown.
When using it as a normally closed contact (B), check the instruction manual and change it to a normally closed contact for work.

Symbol

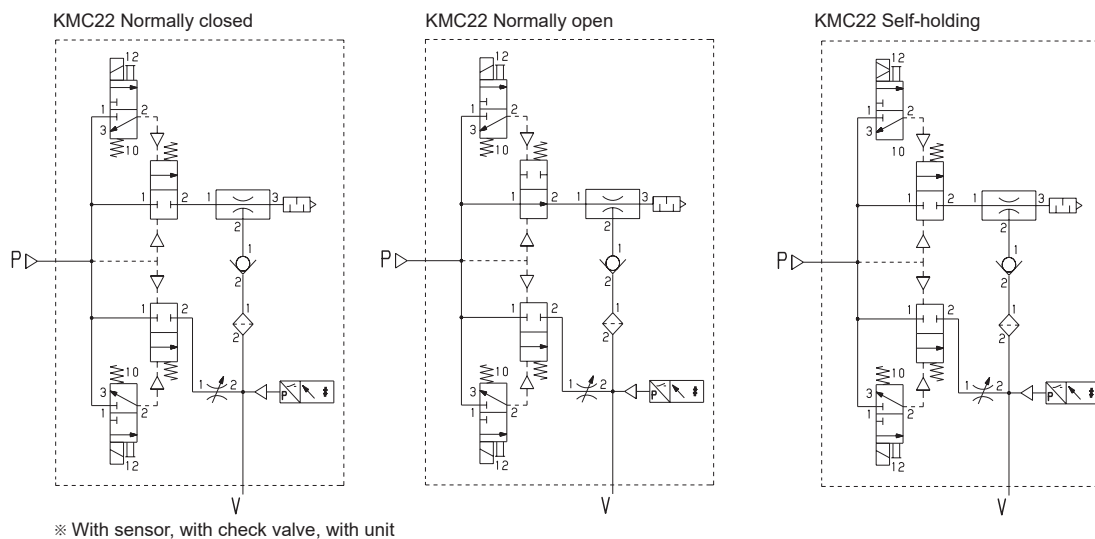

Construction

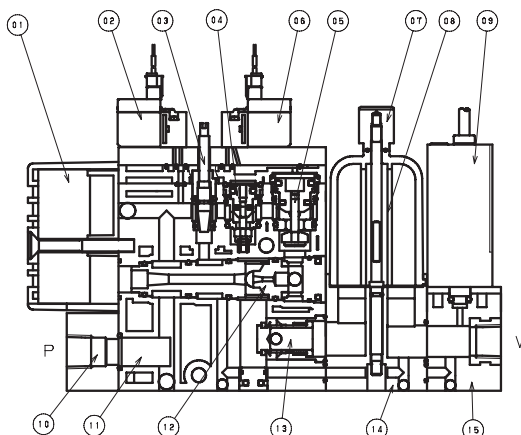

NO	Part name	Material
1	Silencer	PBT, PVF
2	Blow-off valve	-
3	Blow-off flow adjustment needle	SUS, Aluminum, NBR
4	Blow-off poppet valve	Aluminum, NBR, SUS, FKM
5	Vacuum generation poppet valve	Aluminum, NBR, SUS, FKM
6	Vacuum generation valve	-
7	Filter Ass'y	PA, BRASS, NBR
8	Filter element	PVF
9	Pressure sensor	-
10	Supply base	PBT
11	Body	PA
12	Nozzle kit	Aluminum, NBR
13	Check valve	Aluminum, BRASS, NBR
14	Filter base	PA
15	Sensor base	PA

Performance charts

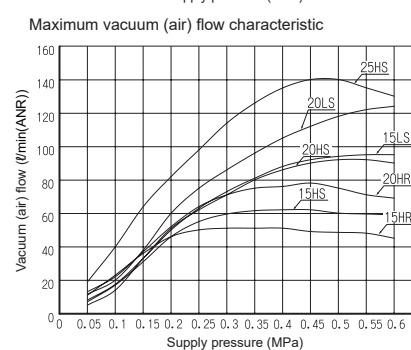
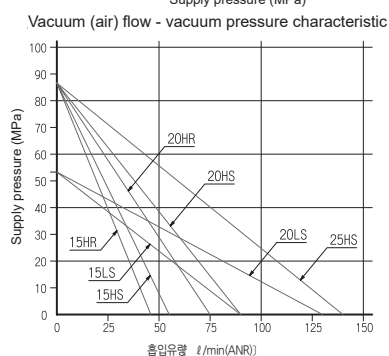
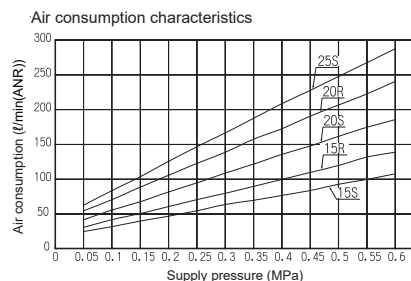
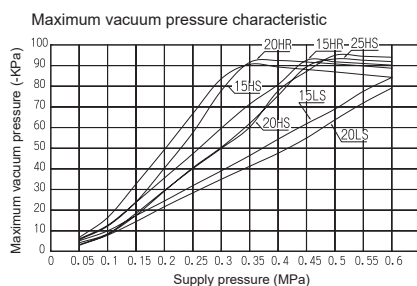

Dimensions

Single unit

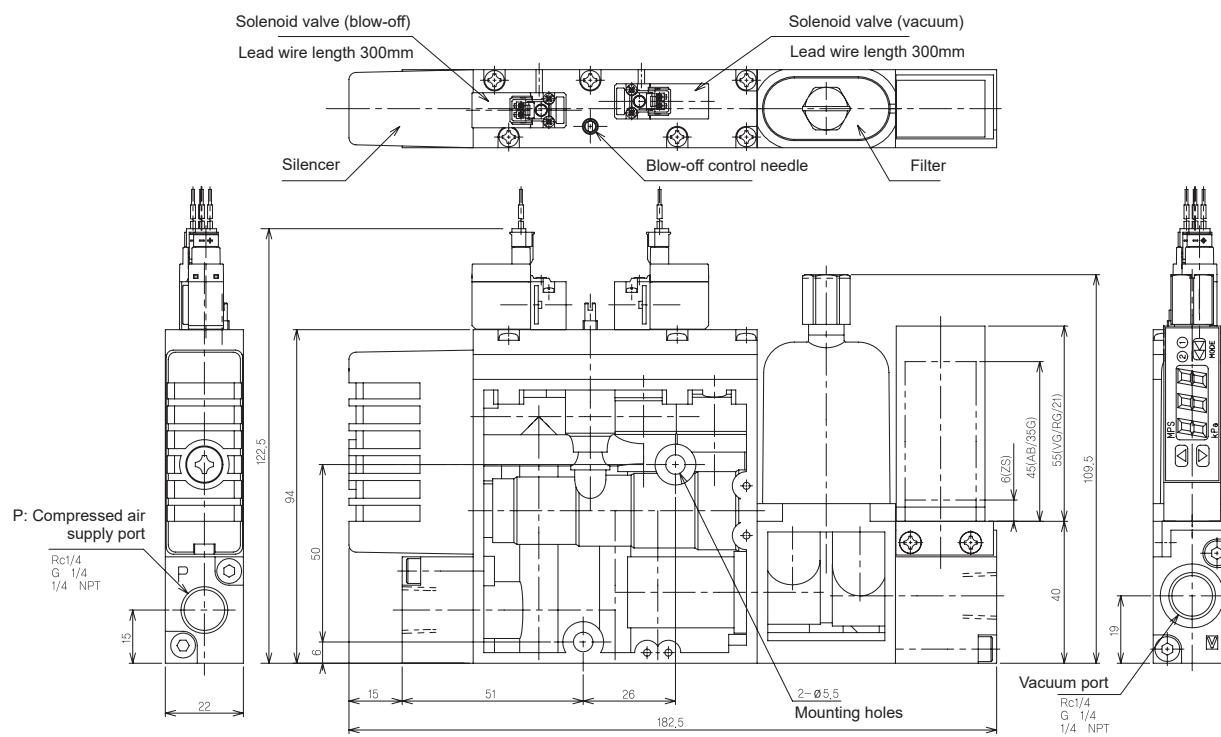

Without sensor unit

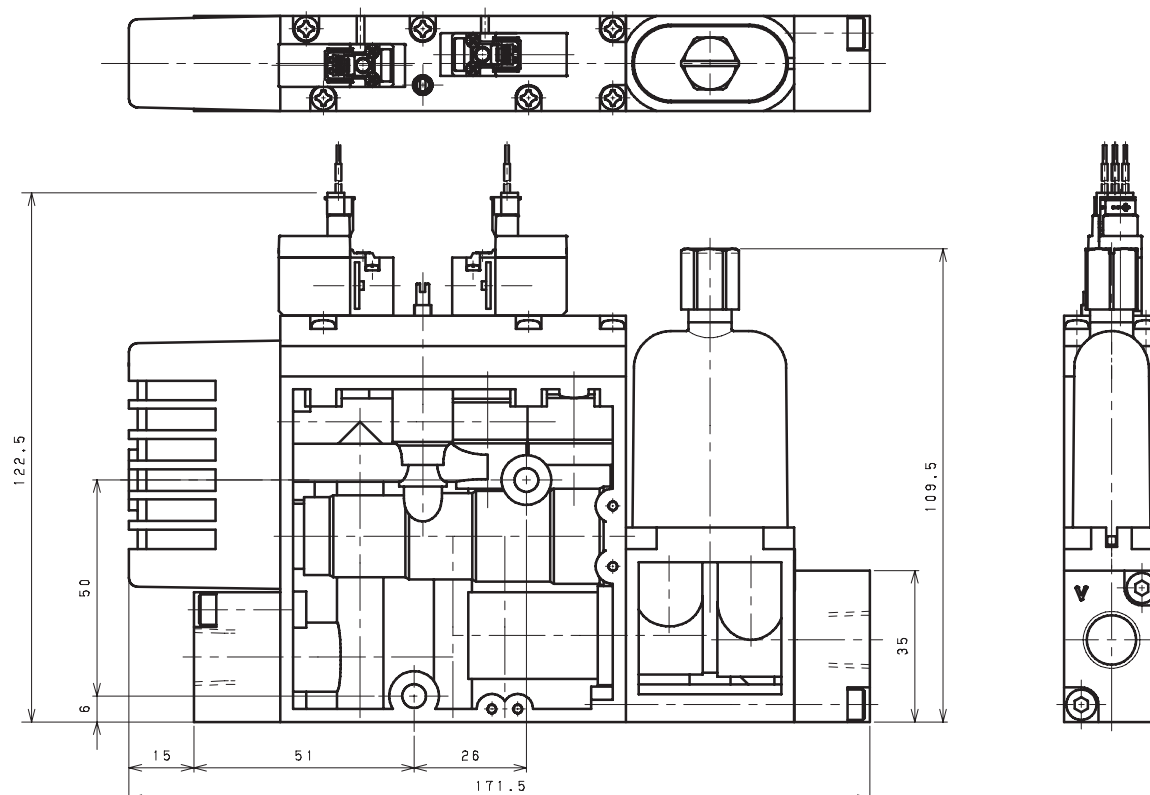

Dimensions

Without filter unit

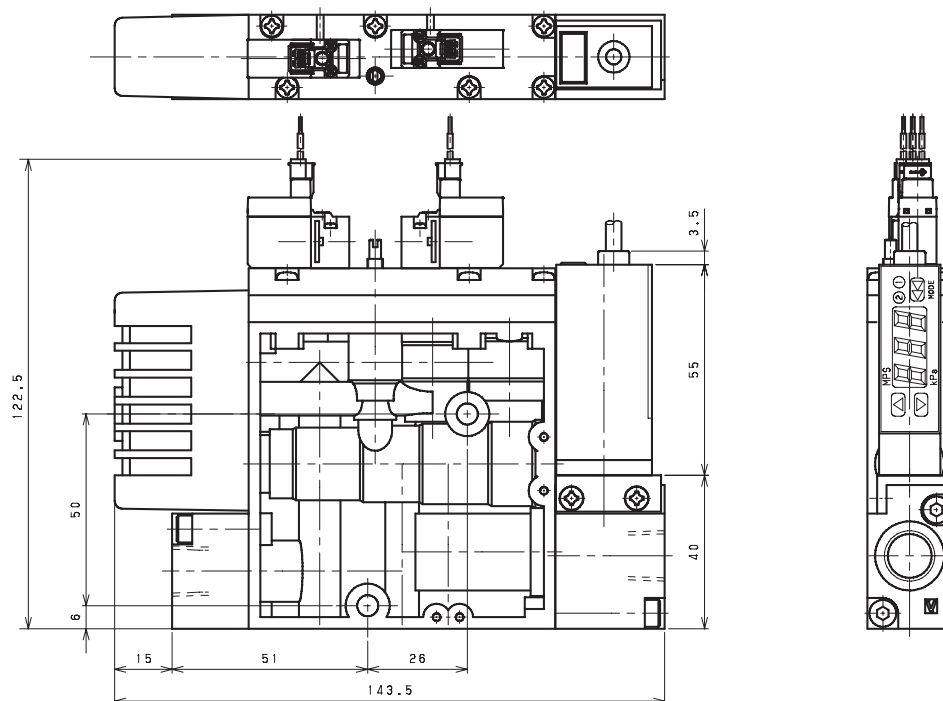

Without sensor, filter unit

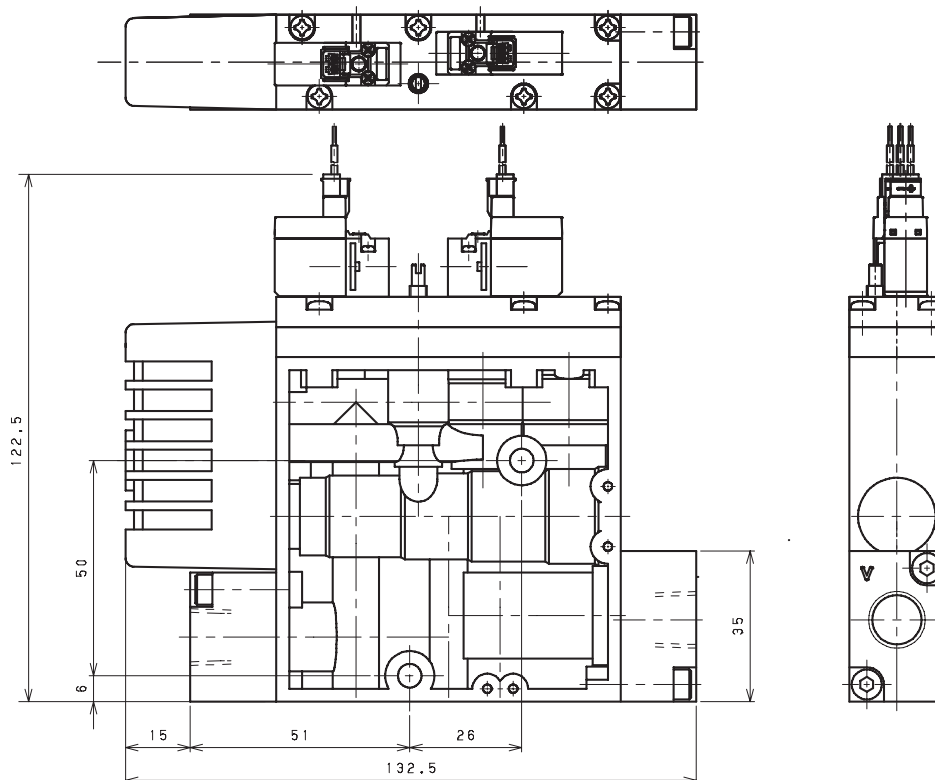

Dimensions

Manifold

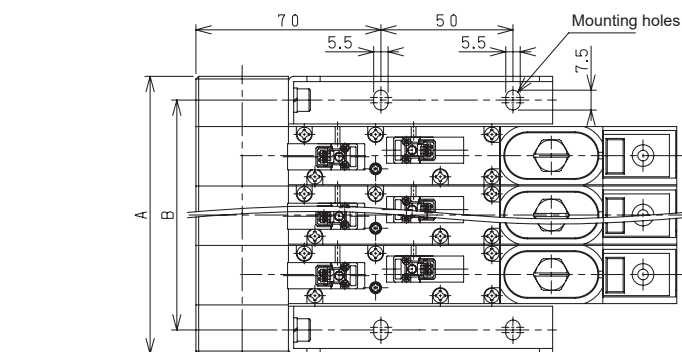

n(number of units)	1	2	3	4	5
A	60	82.5	105	127.5	150
B	42	64.5	87	109.5	132

